

Business and Planning Act 2020

APPLICATION FOR PAVEMENT LICENCE

The completed application form together with the required documents and fee must be sent to;

The London Borough of Newham
Highways and Sustainable Transport
Network Management
Newham Dockside
1000 Dockside Road
London
E16 2QU

Skipsand.Scaffolding@newham.gov.uk

Part B **must** be displayed to the public at the premises upon application, for 14 days

1. Where do you want the pavement licence to apply:

Address of Licence:

129 high street south e6 3pa

Business Name of premises:

Cataleya cakes

The application is for:

(enter quantity) 4
and drink.

Tables and 8

Chairs, for the purposes of serving food

Details of Any other equipment being considered

2. Is the land to be used owned or maintained by

- Newham Council as the Highway Authority:
- Network Rail
- Transport for London (TfL) or any of its subsidiaries

<input checked="" type="checkbox"/>
<input type="checkbox"/>
<input type="checkbox"/>

3 What is the:

- The width of the land that you wish to use:
- The depth of the land that you wish to use:
- Total area of the land that you wish to use :

metres

metres

square metres

2. Applicant Details

First name: vasilie

Family/ Surname Arseni

Address: 129 high street E6 3PA

Business Address (if different from above):

Date of Birth:

Main contact Telephone number:

Mobile Number:

Email address:

Company name: (if applicable):

Registered Office: (if applicable)

Principle Trading address: (if applicable):

Registration number: (if applicable)

3. Application Details:

3.1 Who will you appoint to be in charge of the area used for the tables and chairs
(e.g. manager of premises)

Cristina Ganu

3.1 On what days and during what times do you want to put the tables and chairs on the land (use 24 hour clock):

Day	Start	Finish
Mon	09:00	22:00
Tues	09:00	22:00
Weds	09:00	22:00
Thurs	09:00	22:00
Fri	09:00	22:00
Sat	09:00	22:00
Sun	09:00	22:00

Note: The Council has a standard condition that the hours of operation may only be between **09.00 to 22.00 hours** on Monday to Sunday. The Council will only be prepared to extend those hours in exceptional circumstances. If you wish to trade before 09.00 hours or after 22.00 hours, please give details of the hours and full reasons below:

.....
.....
.....
.....

The Network Management Team reserves the right to restrict times of operation in the interests of the public.

- 3.3 Permissions are normally granted for a 3 month period (renewable subject to payment)
- 3.4 Give a brief description of the types of chairs, tables and barriers that will be used on the Highway including the numbers and what they are made of and their colours.
- 3.5 Give details of the toilet and hygiene facilities that will be provide for persons using the area, including the location of the facilities and their numbers.
- 3.6 What provision you have made for smoking and non-smoking areas for seating
- 3.7 Give details of the steps that you will be taking to ensure that the use of the highway does not cause a public nuisance to either nearby residents/businesses or passers-by. This should include preventative measures to stop noise nuisance that may be caused by patrons using the premises or arriving at or leaving the premises in particular at night.
- 3.8 Give details of the steps that you will be taking to ensure that the use of the highway does not cause or attract anti-social behaviour, crime or disorder in the vicinity (e.g. groups of people attracted by the operation gathering immediately outside the land and causing problems).
- 3.9. What arrangements will be made for the regular collection of any litter or other rubbish in the vicinity of the area that have been caused by the business?
- 3.10 How often will the tables and the land be cleaned of plates, drinking vessels and other utensils, waste, rubbish etc.?
- 3.11 What arrangements will be made for the storage and collection of any litter, waste, rubbish etc.?
- 3.12 What, if any arrangements or measures have you considered/put in place to reduce the risk to customers from vehicle incursions and social distancing?

3.4 Folding silver coloured aluminium chairs x 10

3.5 Toilet facilities not provided (no alcohol served, closes before 11pm at 5pm)

3.6 Ashtrays will be provided in smoking area which will be located right of the entry.

3.7 Solid wooden barriers will separate public area from the dining area.

3.8 No alcohol provided, business closes at 5pm.

3.9 Litter collected Tuesday and Friday from rear of shop.

3.10 Tables cleared after every service.

3.11 Litter collected from rear.

3.12 Wooden barriers demarcate dining area of pavement.

3.13 Please give any other information which you believe will be of assistance to the Council in its consideration of the application

3.14 Please supply a plan clearly showing the proposed area covered by the licence in relation to the highway, if not to scale, with measurements clearly shown. The plan must show the positions and number of the proposed tables and chairs, together with any other items that the applicant wishes to place on the highway. The plan shall include clear measurements of, for example, pathway width/length, building width and any other fixed item in the proposed area.

3.15 a risk assessment demonstrating how the applicant will manage social distancing and the conflict between pedestrians using the footway, those using the tables and those queuing to access the premises,

Documents etc. to be submitted with this application form:

I have enclosed the following documents etc with this application form	State Yes or No
The fee (this can be paid by Credit/Debit card by calling 020 3373 1463)	choose
Plans in accordance with number 3.2(a) and (b)of the Rules Governing Applications	Choose
Proof of any Public Liability insurance	Choose
Photographic evidence of placement of notice in Part B. showing prominent location in premises window and overview of location in relation to premises as a whole showing Part B form displayed.	Choose

Declaration of Applicant

1. I hereby declare that:

- a) I have read the Councils:
 - Rules Governing Applications
 - Standard Conditions
 - Guidelines For Determination of Applications
- b) I am aware that 'tacit approval' does not apply to this application
- c) The details contained in this application and any attached documents are correct to the best of my knowledge and belief.

2. I/we hereby further declare that I/we shall indemnify and save harmless the Council of the London Borough of Newham against any claim in respect of injury, damage or loss arising out of the grant of the permission that is not attributable to the negligence of the Council

Signed: *A. auf der Mauer*

Print Name Arlene auf der Mauer

Dated 09/12/2022

HIGH STREET SOUTH

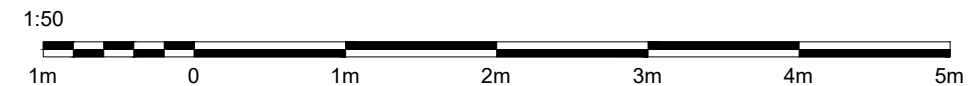
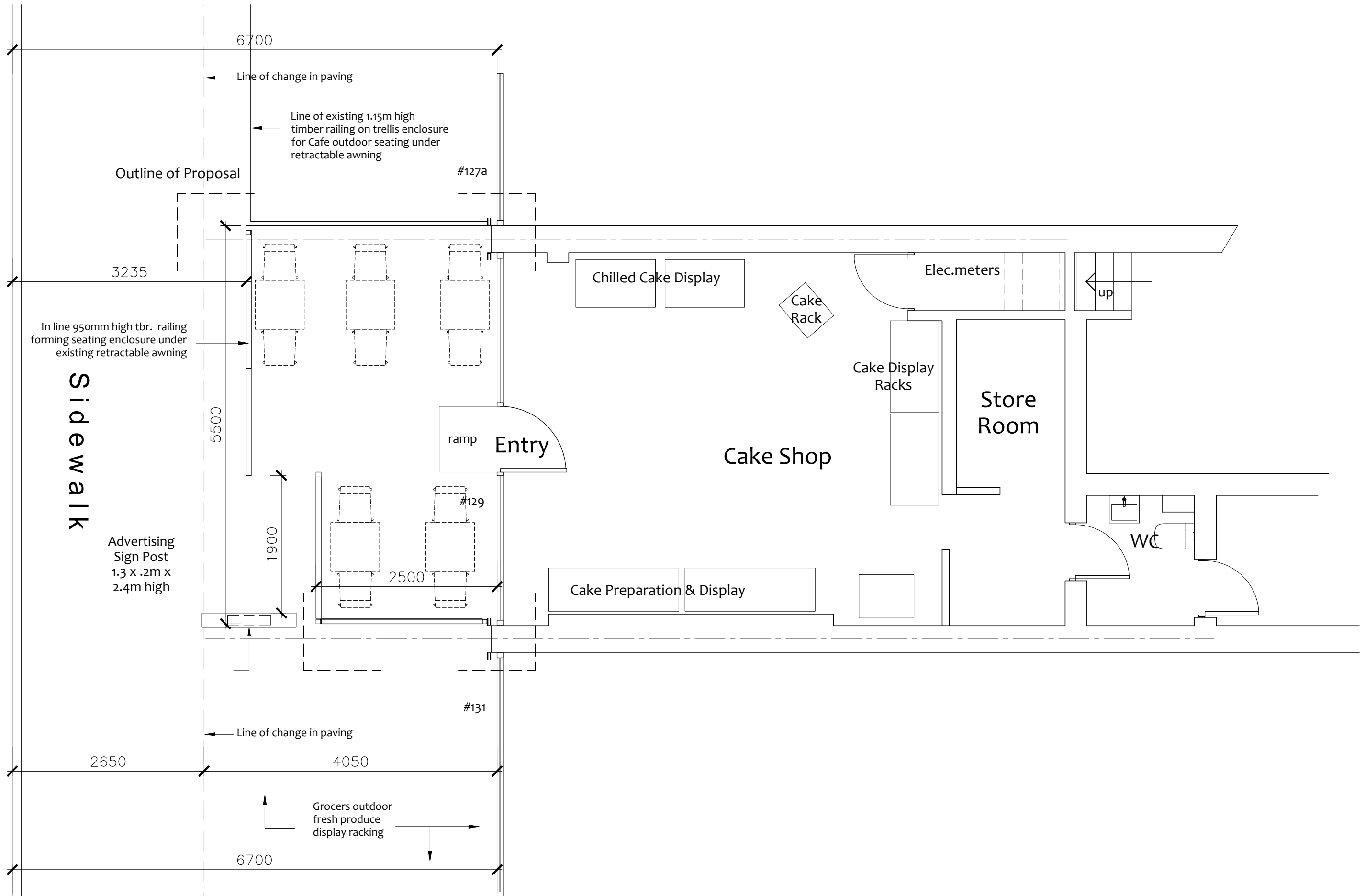

Address: <i>The Bakery</i> 129 High Street South, London E6 3PA	Project Pavement Licencing	Revision	Scale 1/50@A3	Dwg.No. PAV-02
	Drawing Title Pavement Plan	Date Oct 10 2022	Checked	Project No. RHA-10-22-B

A.D.M Food Safety & Licencing
 Mob: 07950 685397
 Em: admtraining58@gmail.com

R.Hadidian & Associates
 CHARTERED ARCHITECTS
 44b High Road, Willesden London NW10 2QA
 Tel:07476845478 Em: rhadidian@gmail.com

Size:
A3

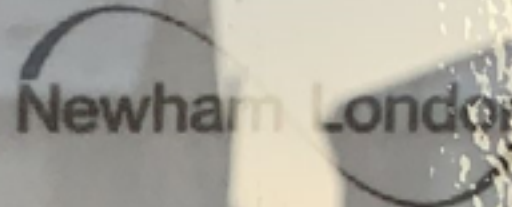

Part B: Site Notice Template for display by an applicant for a Pavement Licence.

**Sec. 4(1) the Business and Planning Act 2020.
Application for a Pavement Licence**

I/We *(insert name)*, Vasile Alexandru Arseni

do hereby give notice that on *(date)* 09/12/22, have applied to Newham Borough Council for a 'Pavement Licence' at:

(postal address of premises)
129 high street E6 3PA

known as *(Premises Name)*;

Cataleya cakes

The application is for:

(brief description of application (e.g outdoor seating to the front of the premises for serving of food and drink)

outdoor seating in the front of the premises for serving food and drink

Any person wishing to make representations to this application may do so by writing, preferably by email, to:

The London Borough of Newham
Highways and Sustainable Transport
Network Management
Newham Dockside
1000 Dockside Road
London
E16 2QU
Skipsand.Scaffolding@newham.gov.uk

by: 16/12/2022

(last date for representations being the date 7 days after the date the application is submitted to the local authority (excluding public holidays))

The application and information submitted with it can be viewed on the Council's website at: www.newham.gov.uk/pavementlicence

Signed 

Dated : 09/12/2022

(date the notice was placed which must be the same date as the date of application)

129



CATALEYA CAKES



COFETARIE

☎ 07884 594 071

HANDBAKE WITH LOVE

f CATALEYA CAKES

MINI MA LA ZC

CHRISTMAS
CAN BE
CHALLENGING
SENDING
PRESENTS
IS EASY.

Save money.
Buy your postage online
and we'll collect for you.
Visit royalmail.com
CLICK. SAVE. WE COLLECT.

OPEN
Welcome

TALK HOME TALK HO to der

Auto
Trader

Auto
Trader

Auto
Trader

SANTA
HERE!

TRACE
RECALL

CHRISTMAS

valit